

# Installation Instructions

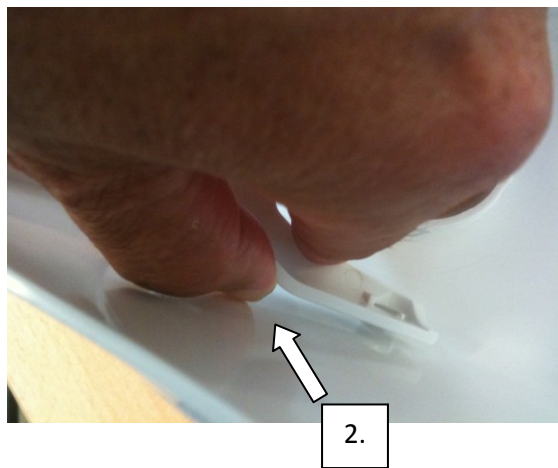
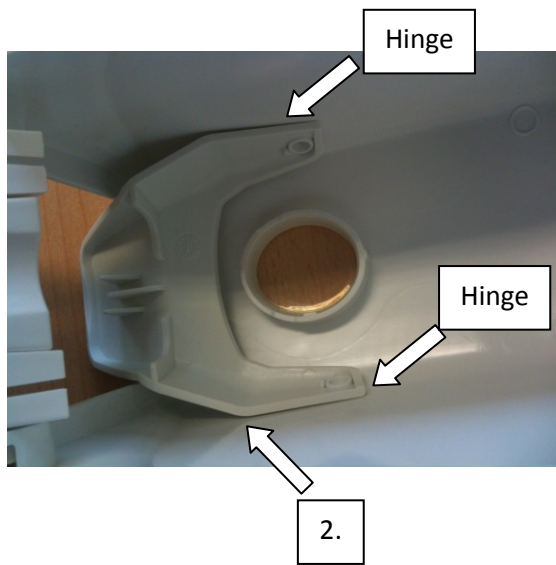

Instructions for removing and installing the Aquarius button on the Aquarius Soap dispenser.

1. Open the cover by pushing the hidden lock located underneath the dispenser.
2. Slightly push the button towards the middle of the dispenser so it comes off the hinge.
3. Install the new red button by first placing the button hole over the one hinge.
4. Then, as in removing the button, but in reverse order, slightly push the button towards the middle of the dispenser so it fits over the other hinge.
5. Ensure the button moves freely underneath the opening of the dispenser without falling off.